

ANTLERS

@AntlersGallery

#YouMoveMe

You Move Me

Jo Lathwood

Synnøve Fredericks

Helen Jones

Olivia Jones

Laurie Lax

Anna Barrett

ADMISSION FREE

29 NOV - 23 DEC,
MON - FRI, 10 - 7 // SAT + SUN 12 - 4

5 - 10 JAN,
MON - FRI, 10 - 7 // SAT + SUN 12 - 4

CREATE CENTRE, SMEATON ROAD, SPIKE ISLAND, BRISTOL, BS1 6XN

YOU MOVE ME

You Move Me is a new exhibition by Antlers Gallery for Winter 2014/15.

This exhibition revolves around a site-specific installation by Bristol-based artist Jo Lathwood. Jo's installation takes the form of a wooden tunnel-like structure that you are invited to walk through and explore; an intervention that breaks out of the Create Centre exhibition space. Off this main framework a select group of artists have been commissioned to respond to Jo's work and depict their interpretation on its themes - with a focus on drawing in the broadest sense. The invited artists are: Helen Jones, Laurie Lax, Olivia Jones and Synnøve Fredericks. Lighting Designer Anna Barrett has created a bespoke lighting scheme that interplays with the exhibition.

These commissions aim to affect the aesthetic and layout of Jo's structure creating an exhibition that is neither a collaboration nor a group-show; instead promoting a different format that lies somewhere between these two expected modes.

You Move Me takes direct inspiration from the 'hidden' River Frome that runs underneath Bristol city centre. The work transposes the path of the river and interference patterns allude to the movement and flow of water. In creating an immersive environment Jo wants to explore themes of (re)viewing familiar spaces around the city, and examine ways in which nature and the urban environment interrelate.

The central installation is primarily built from natural / found materials - supporting a sense of nature within an urban context, an overlap that is present in both the work and the city. The participatory nature of the piece (you have to physically navigate the passageway) builds connections with the work and supports a sense of fun and adventure.

Join the conversation and share your experience on Instagram, Facebook and Twitter with:
#YouMoveMe / @AntlersGallery

FLOOR PLAN AND WORKS

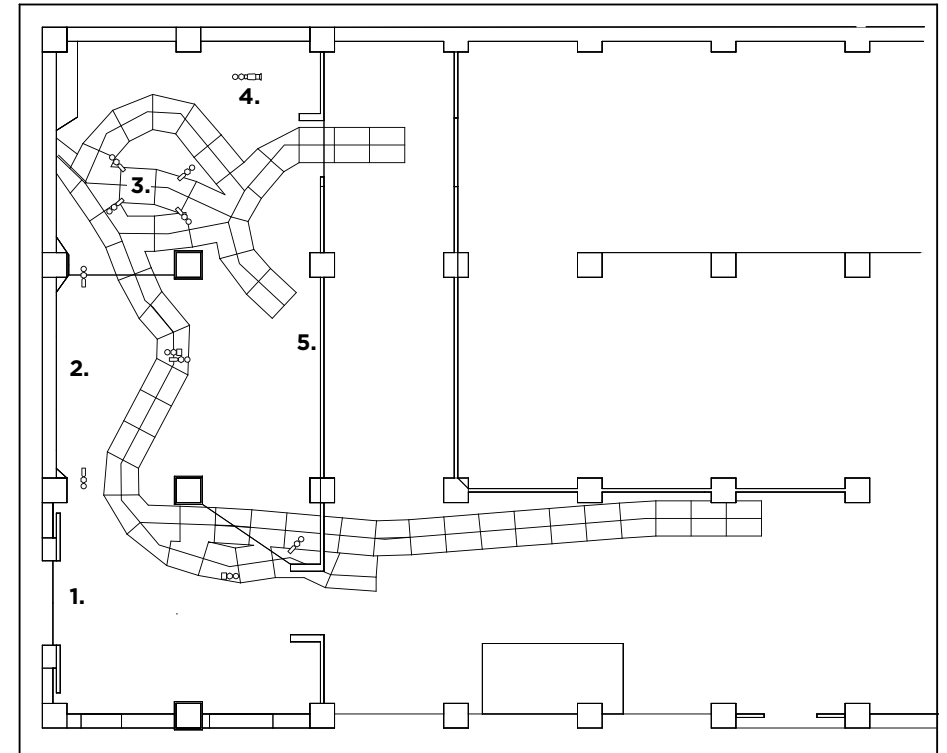

Jo Lathwood - *You Move Me* - Recycled Wood and Cardboard

1. Laurie Lax - New Cut IV - River Silt
2. Laurie Lax - New Cut III - Graphite on Paper and Wooden Plinth
3. Olivia Jones - *Rót Rót Root* - Plywood & Acrylic Mirror
4. Synnøve Fredericks - Waiting, Watching & Waiting - Recycled Wood, Pyrex Vessels, Theatre Light, Cord
5. Helen Jones - Undercurrent I & II - Black Pigment and Pastel on Tracing Paper

EVENTS

ALL ARTIST TOUR OF EXHIBITION (1):

Saturday 6th December, 2pm

JO LATHWOOD ARTIST TOOL KIT:

Wednesday 10th December, 6.30pm

JO LATHWOOD ARTIST TALK:

Saturday 20th December, 2pm

ALL ARTIST TOUR OF EXHIBITION (2):

Wednesday 7th January, 6.30pm

LOCATION:

Create Centre, Smeaton Road,
Spike Island, Bristol, BS1 6XN

All events are free – but require a RSVP. Please email admin@antlersgallery.com with the name of the event and how many people will be attending in the subject line

This exhibition is supported using public funding by Arts Council England

www.antlersgallery.com

PURCHASING

All works are available to buy and commissions can be discussed.

Antlers Gallery supports the Own Art scheme – making buying art more affordable for everyone through interest free loans.

Please approach a member of gallery staff with any enquiries you may have or contact Jack on:

jack@antlersgallery.com //

07780 503 180



Supported using public funding by
**ARTS COUNCIL
ENGLAND**

VNTLERS